



GENEBRE PART: 2983 SANITARY 90 DEGREE CLAMP ELBOW



SPECIFICATIONS

1	Made of AISI 316L
2	Sanitary Polish - internal and external
3	Made according to BS 4825-3 Standard
4	Max Working Pressure 10Kg / cm2

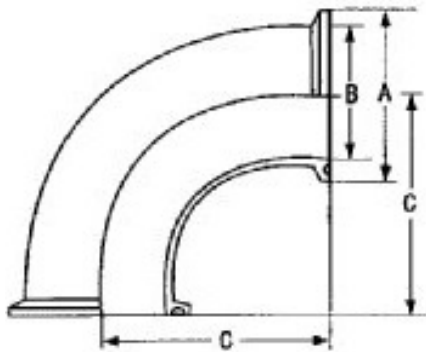

DIMENSIONS

AVOL REF	SIZE Mm	PN	A	B	C	Wt (Kg)
2983 04	1/2"	10	25.4	9.5	41	0.050
2983 05	3/4"	10	25.4	15.4	41	0.055
2983 06	1"	10	50.5	22.4	55	0.180
2983 08	1 1/2"	10	50.5	35.1	70	0.190
2983 09	2"	10	64	47.8	82	0.340
2983 10	2 1/2"	10	77.5	59.5	105	0.630
2983 11	3"	10	91	72.2	110	0.750
2983 12	4"	10	119	97.6	148	1.580